

---

URBAN MIXED-USE COMMUNITY AND COMMERCIAL SPACE

---



**STATION**  
**WEST**

---

901 & 919 BERRYHILL ROAD, CHARLOTTE, NC 28208

---

# STATION WEST



**DOWNTOWN  
VIEWS**



**FREEMOREWEST**

**175**



**PARKING SPACES**

**EASY ACCESS TO**

**I-77  
& I-277**



**RETAIL TENANTS INCLUDE:**



THE BATCH HOUSE, BACKDROP  
COFFEE AND DELECTABLES BY HOLLY  
CATERING

**16'**

**CEILING HEIGHT**

**THE UNION SHARED OUTDOOR  
PATIO AREA AND MULTIPURPOSE SPACE**



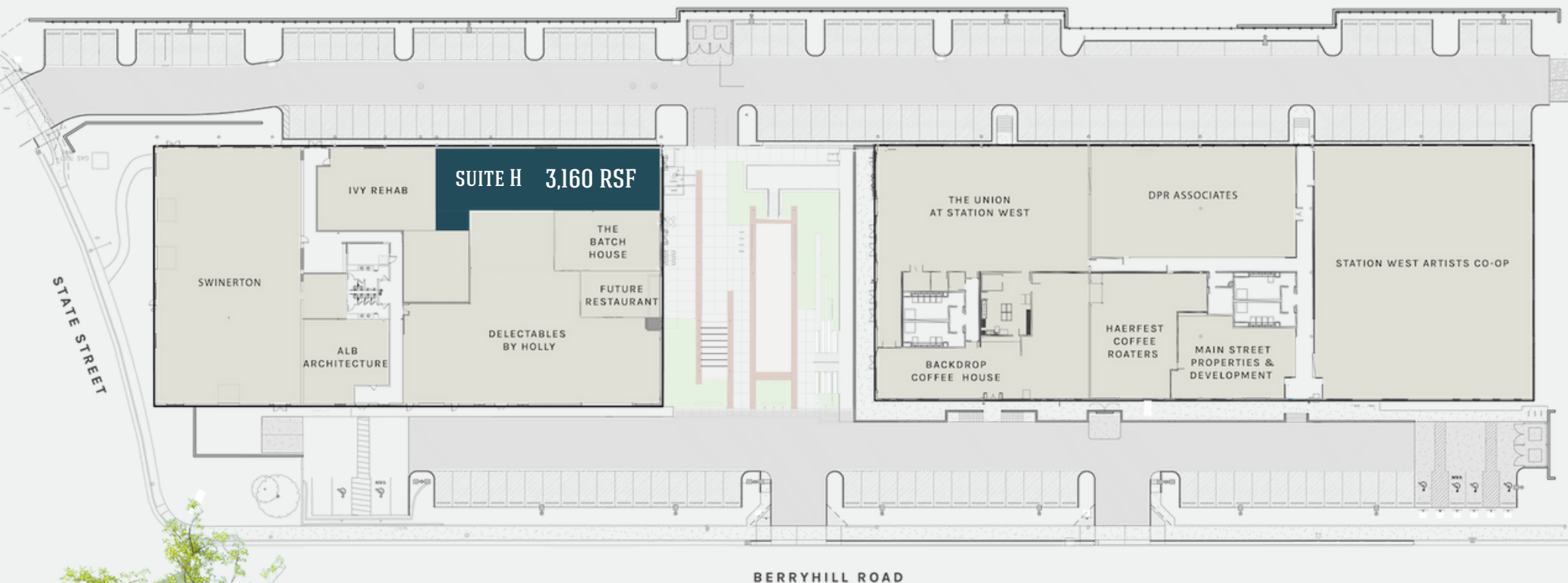



## community.

The Union @ Station West offers tenants and visitors an outdoor multi-purpose communal space complete with terraced gardens and seating, a food truck zone, and adaptable furniture for various types of groups and events.



# NEIGHBORHOOD RETAIL



**Enderly**  
Coffee Co.  
SINCE 2012  
CHARLOTTE, NC

**LuLu's**  
FRYHOUSE

**NOBLE SMOKE**  
barbecue  
**Bossy Beulah's**  
CHICKEN SHACK  
Since 2017

**MIDNIGHT MULLIGAN**  
BREWING

**WALKER ZANGER**  
A. HOKE LTD

**PIZZA Babys**  
BAR + SITES  
**RUNAWAY**  
WHISKEY & WINE  
**the coterie**  
WELLNESS STUDIO

**Heritage**  
CREATED LOCAL - EMPLOYED LOCALS  
**SLATE**  
INTERIORS

**PINKY'S**

**SALT + VINEGAR**  
**LEGION**  
BREWING  
**counter-**  
**bblo**

**DUNKIN'**

**Bicycle Sport**

**EXIT 9**

5-MINUTE DRIVE TO  
UPTOWN & BANK OF  
AMERICA STADIUM



**SAVONA MILL**  
**BLUE BLAZE**  
BREWING CO.  
ESTABLISHED 2012

**STATION WEST**

**LOWER TUCK**  
**NOT JUST COFFEE**  
**MAIZ AGUA SAL**  
RESTAURANT & BAR

**Lucky Dog**  
BARK AND BREW  
**AZUL** **COLEY HOME**  
THE CITY BREWERY  
TICKET

**MOREHEAD CORNERS**  
**RHINO MARKET & DELI**  
**TOWN BREWING CO.**  
**FREEMORE TAVERN** **QUE Pasa!**  
ESTABLISHED 1988

**THE BEAR**

**SUMMER CLASSICS**

# NEARBY DEVELOPMENT

## UNDER CONSTRUCTION

1. Retail - 10,000 SF
2. Office - 6,000 SF
3. Office - 15,500 SF
4. Retail/Office - 29,000 SF
5. Multifamily - 213 units
6. Multifamily - 321 units  
Office - 200,000 SF

## PROPOSED

1. Multifamily - 450 Units
2. Future large mixed-use
3. Retail/Office - 42,000 SF
4. Retail/Office - 60,000 SF
5. Retail/Office - 24,000 SF
6. Retail - 12,500 SF



GET IN TOUCH ▾



JAY MITCHENER

JAY@THRIFTCRES.COM

(704) 576-2772

ALEX MANN

ALEX@THRIFTCRES.COM

(703) 623-7002

STEPHEN WOODARD

STEPHEN@THRIFTCRES.COM

(704) 905-4309

